

# Ins-30010 Switch2 control unit

## Technical Support

☎ 01273 811011

✉ [support@paxton.co.uk](mailto:support@paxton.co.uk)

Technical help is available: Monday - Friday from 07:00 - 19:00 (GMT)  
Saturday from 09:00 - 13:00 (GMT)

Documentation on all Paxton products can be found on our website - <http://www.paxton.co.uk/>

## Quickstart guide

This supplement is a brief guide to installing a Switch2 system. Further information is available for download at: <http://paxton.info/45> or call the communications team on: **01273 811011**.

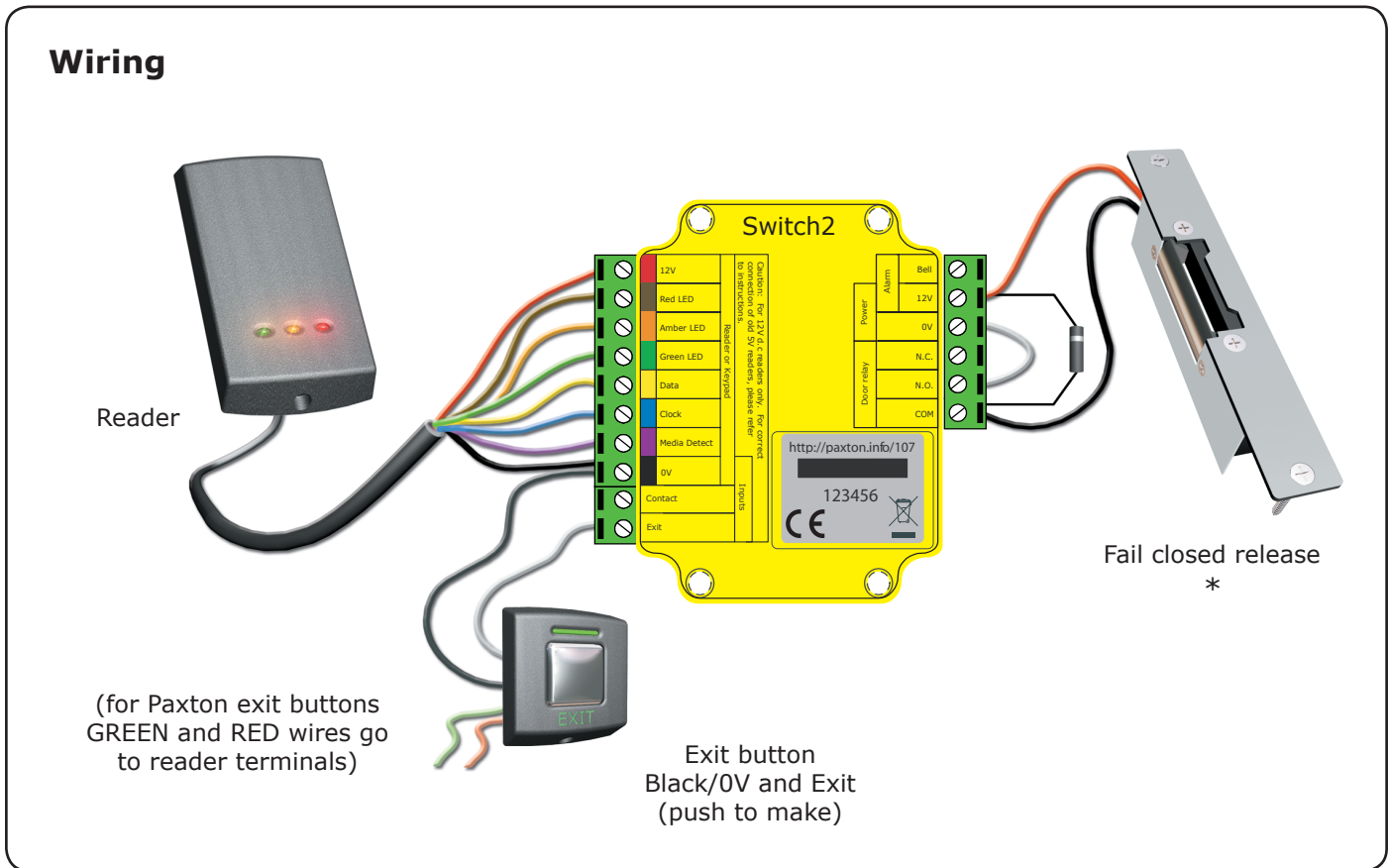

To change a reader port voltage to 5V, move the red jumper(s) located beneath the wiring label to the 5V setting.

## Fail open locks

\* For a fail open lock (Maglock), the 0V loop wire is connected to the "N.C." terminal. (not the "N.O.")

This product is not suitable for retail sale. All warranties are invalid if this product is not installed by a competent person.

## INITIALISING A NEW SYSTEM

The first time the system is powered up the control unit will beep 3 times a second. This indicates the unit needs programming. There are 3 programming options:

Using tokens only (CARDLOCK or PROXIMITY) see Section 1

Using codes only (TOUCHLOCK) see Section 2

Using tokens and PIN/codes (CARDLOCK/PROXIMITY with TOUCHLOCK) see Section 3

The reader's default indication has all the LED's on. Access granted is denoted with a single flashing Green LED, Access Denied is a single flashing Red LED.

## Section 1 - CARDLOCK or PROXIMITY

### Enrolling a card pack.

Present/swipe enrolment card



All tokens will now be validated.  
Tokens can now be issued to users

**Adding an additional Proximity card pack.** You need to be in possession of a valid enrolment card for this system. Present this enrolment card to the reader and the Amber LED will flash with the Green & Red LED's off. Present the Enrolment card from the new card pack. The reader will beep and all LED's will be lit. The additional cards will now be valid. Repeat this with each reader and with any additional card packs. Any valid enrolment card can be used to add further packs. If an incorrect enrolment card is used to start the process, the Red LED will be lit and the reader will produce a squeak sound as it rejects the card.

**To bar a user:** Present/swipe user's shadow card  
The user card is now barred



A user can be re-validated by showing the enrolment card followed by the user card or re-entered if used in Card+PIN mode.

## Section 2 - TOUCHLOCK

Choose a 6 digit Programming Code and load this into the unit as follows:

DO NOT USE 123456 - The default User Code will open the door before the Programming Code had been fully entered.



The default user code is now set to 1234

You can now set up the user codes and features using the programming chart.

Example: - Setting a user code to unlock the door under Normal conditions.

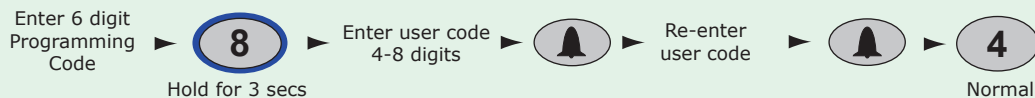

## FACTORY RESET

1. Disconnect power
2. Disconnect GREEN and MAUVE wires
3. Insert link wire between GREEN and MAUVE terminals
4. Reconnect power - unit will beep 4 times
5. Disconnect power
6. Remove link wire
7. Reconnect GREEN and MAUVE wires
8. Reconnect power - unit will beep 3 times a second
9. Proceed with Initialising a new system

This box can be used to write down the Programming Code for future reference. Ensure that this information is stored in a secure place.

--	--	--	--	--	--

**START** - Enter the **6 digit Programming Code** and hold down a function key for **3 seconds**. - The unit beeps and the LED flashes faster.  
Continue the key sequence to set the option - The keypad returns to operating mode.

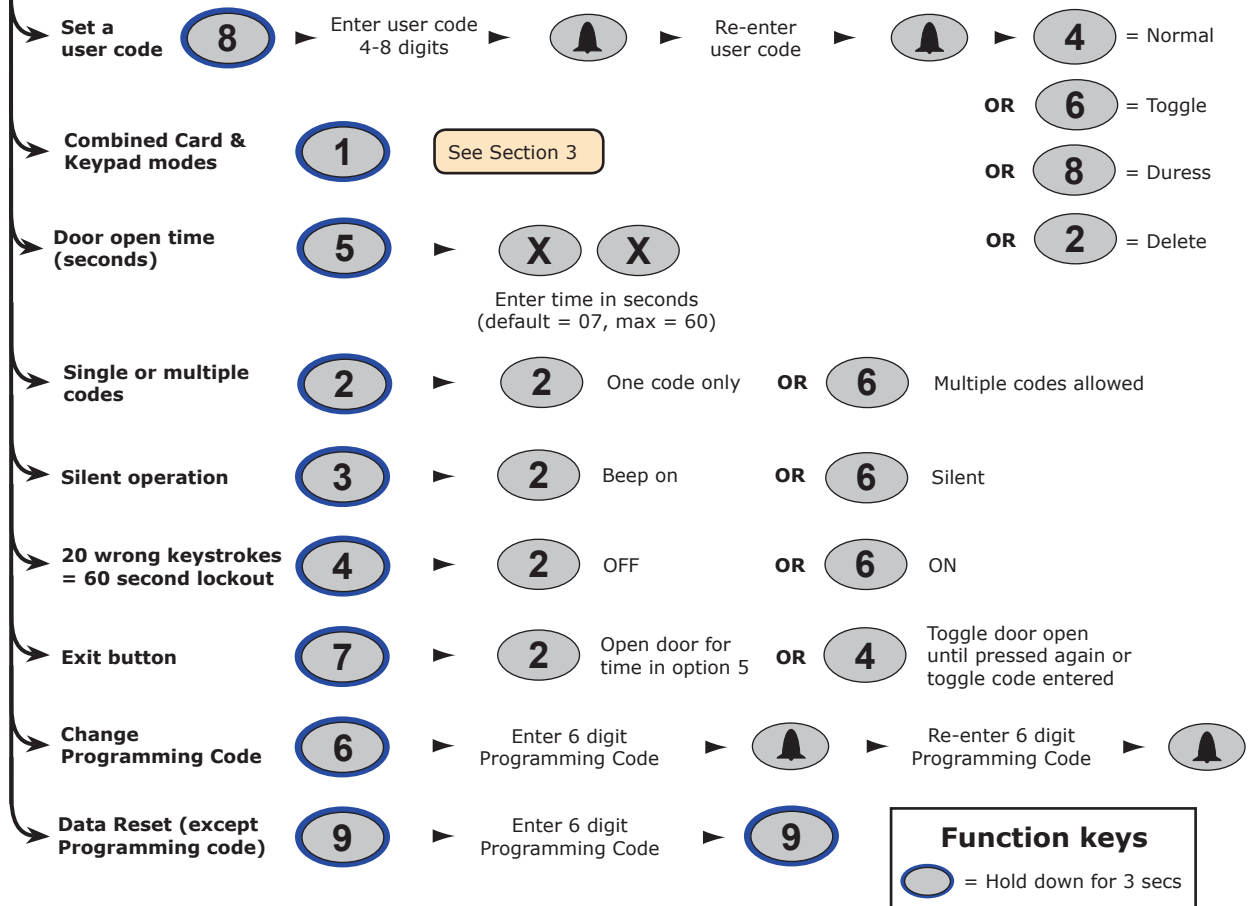

**Section 3 - CARDLOCK/PROXIMITY with TOUCHLOCK mode**

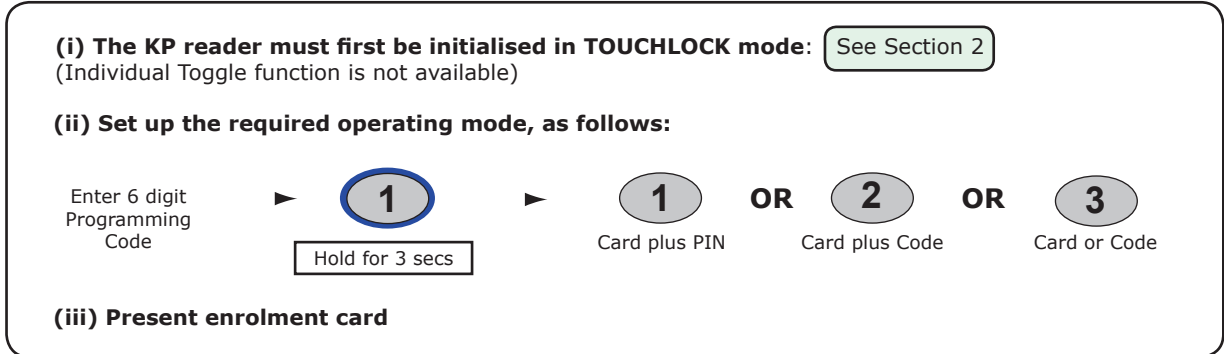

**Card plus Code.** Access is granted by presenting a valid token and then entering a valid user code.  
**Card or Code.** Access is granted by presenting a valid token or entering a valid user code.  
Touchlock programming - Function 2 to enable multiple user codes, Function 8 to add user codes. (4 digits)

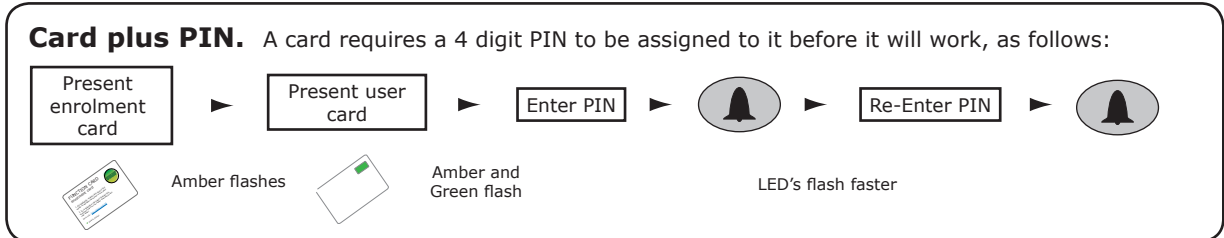

## Technical Help

Here is the list of topics about this product that receive the most technical support enquiries. We list them here to help you speed up the installation and trouble shooting process.

### 1 - How to reset the controller. - See Main Text

### 2 - Two readers on the same controller.

Simply wire the PROXIMITY or CARDLOCK readers in parallel, colour for colour. It is possible to mix 5V and 12V readers. The jumper on the Switch2 must be set to provide 5V at the Red terminal and the 12V reader must then be powered directly from the 12V terminal.

### 3. - Replacing a white labelled control unit. (pre 2004 design)

On a White labelled unit the Red voltage terminal output was 5V DC. The new Yellow labelled unit has this output set to 12V DC. For systems where 5V readers/keypads are to be used, readers must not be connected to yellow label controllers until the jumper setting has been changed on the controller PCB. NOTE: The Touchlock membrane keypad is not compatible with this control unit.

### 4 - Initialising with 2 keypads.

Either Keypad can be used to initialise the controller when using K-Series Keypads. Connect all wires in parallel, colour for colour. If you are using the older Touchlock/SS then you must use the master keypad which has the yellow wire connected to yellow terminal. (The slave keypad will have the yellow wire connected to the mauve terminal.)

### 5 - Bell/Alarm Output.

A 12V DC alarm sounder can be wired between the 12V and Bell terminals. This output is capable of driving a 12V bell/buzzer up to 1A. This load must be taken into consideration when selecting a suitable rated power supply. If door contacts are fitted on a Switch2 system, across the Black and Contacts terminals, the bell/alarm output is activated when the door is forced. On a Switch2 system using a keypad, the bell would normally activate this output. However, when using a door forced alarm, the bell on a keypad will not activate the bell/buzzer connected to this output.

Specifications			CE
Features	Min	Max	
Number of Users	1	10,000	
Number of Codes		50	
Code length	4 digits	8 digits	
Number of PIN's		3,000	
Readers per interface	1	3	
Door open time	1 sec	60 secs	
Time zones (with additional time clock)	1	2	
Access levels (Colour Zones)	1	3	
Silent operation			Yes
Can be used with fail OPEN locks			Yes
Can be used with fail CLOSED locks			Yes
Exit button input			Yes
Door Contact input			Yes
Alarm/bell output voltage			Yes
Electrical	Min	Max	
Voltage	11V DC	14V DC	
Current		80 mA	
Relay switchable voltage		24V DC	
Switchable current		4 A	
Environment	Min	Max	
Operating temperature	-20 °C	+55 °C	
Waterproof	NO - If used externally, it must be protected in a plastic weatherproof housing		
Dimensions	Width	Height	Depth
Control Unit	71 mm	70 mm	23 mm
Plastic Cabinet	200 mm	200 mm	75 mm